

NOTICE!!

These documents have been scanned!

Do not place un-scanned documents beneath this notice!

Do not remove this notice from this file!

GPO Jacket No. 560-102
Print Order 61540
Rise Business Services, LLC
Job=AZ15 6/24/2019



Box Number= AZ15126



Claim Begin-End: AMC428294-AMC428295

1 Initial Receipt



AZ15126-3 AMC428281-AMC452898

AMC#	DATE CLOSED	REMARKS
428294		
428295		

United States Department of the Interior
Bureau of Land Management
 LANDS/RECREATION & PLANNING
 ONE N CENTRAL AVE
 PHOENIX, AZ 85004 -2203
 Phone: 602-417-9200

ENTERED
 JUN 17 2014
 BY: RAM

Receipt

No: 3048448

Transaction #: 3139162	
Date of Transaction: 06/03/2014	
CUSTOMER:	
	IVY MINERALS INC PO BOX 2532 BOISE, ID 83701-2532 US

LINE #	QTY	DESCRIPTION	REMARKS	UNIT PRICE	TOTAL
1	2.00	LOCATABLE MINERALS / MINING CLAIMS-NEW, UNADJUD, ONE OR MORE AUTH NOS / NEW MINING CLAIM LOCATION FEE \$34 CASES: AMC428294/\$34.00, AMC428295/\$34.00		- n/a -	68.00
2	2.00	LOCATABLE MINERALS / MINING CLAIMS-NEW, UNADJUD, ONE OR MORE AUTH NOS / NEW MINING CLAIM MAINT FEE \$140 CASES: AMC428294/\$140.00, AMC428295/\$140.00		- n/a -	280.00
3	2.00	LOCATABLE MINERALS / MINING CLAIMS-NEW, UNADJUD, ONE OR MORE AUTH NOS / NEW MINING CLAIM PROCESSING FEE CASES: AMC428294/\$20.00, AMC428295/\$20.00		- n/a -	40.00
4	1.00	IAC PRODUCTS / COPIES/PLOTTERS / CASEFILE/DOCUMENT COPIES / COPIES (B/W UP TO 11X17)		0.13	0.13
TOTAL:					\$388.13

PAYMENT INFORMATION			
1	AMOUNT:	388.13	POSTMARKED: N/A
	TYPE:	CHECK	RECEIVED: 06/03/2014
	CHECK NO:	4107	
	NAME:	RYBERT, GEORGE E 534 PRESCOTT HEIGHTS DR PRESCOTT AZ 86301 US	

REMARKS

NOTICE!!

These documents have been scanned!

Do not place un-scanned documents beneath this notice!

Do not remove this notice from this file!

GPO Jacket No. 560-102
Print Order 61540
Rise Business Services, LLC
Job=AZ15 6/24/2019



Box Number= AZ15126



Claim Begin-End: AMC428294-AMC428295

2 Correspondence



AZ15126-3

AMC428281-AMC452898

**NO
DOCUMENTS
FOUND**

NO DOCUMENTS FOUND
NO DOCUMENTS FOUND

NOTICE!!

These documents have been scanned!

Do not place un-scanned documents beneath this notice!

Do not remove this notice from this file!

GPO Jacket No. 560-102
Print Order 61540
Rise Business Services, LLC
Job=AZ15 6/24/2019



Box Number= AZ15126



Claim Begin-End: AMC428294-AMC428295

3 Transfers



AZ15126-3

AMC428281-AMC452898

**NO
DOCUMENTS
FOUND**

NO DOCUMENTS FOUND
NO DOCUMENTS FOUND

NOTICE!!

These documents have been scanned!

Do not place un-scanned documents beneath this notice!

Do not remove this notice from this file!

GPO Jacket No. 560-102
Print Order 61540
Rise Business Services, LLC
Job=AZ15 6/24/2019



Box Number= AZ15126



Claim Begin-End: AMC428294-AMC428295

4 Annual Filings



AZ15126-3 AMC428281-AMC452898

427575

428294

**Ivy Minerals Inc
P. O. Box 2532
Boise, Idaho 83701.**

June 16, 2017

VIA FEDERAL EXPRESS

United States Bureau of Land management
Suite 800
One North Central Avenue
Phoenix, Arizona 85004-4427

Re: Maintenance Fee Payment for GB-1 through GB-5 Claims
Mohave County, Arizona

**BLM Serial #'s IMC # 427575 through #427577
and IMC# 428294 and #428295**

Greetings:

Enclosed is a check in the amount of \$775.00 in payment of the Maintenance Fees due on or before September 1, 2017 for the above referenced unpatented lode mining claims. I have enclosed a self-addressed stamped envelope for returning the receipt.

Thank you for your help in this matter.

Sincerely,

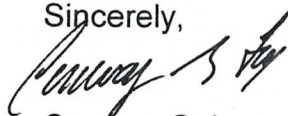

Conway G. Ivy
President

PHOENIX, ARIZONA

2017 JUN 20 P 2:37

RECEIVED
BLM AZ STATE OFFICE

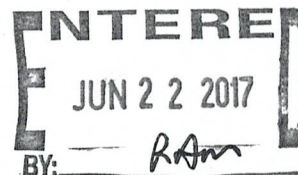

3867508

**UNITED STATES BUREAU OF LAND MANAGEMENT
CLAIM MAINTENANCE FEES**

June ~~22~~₁₆, 2017

For
Ivy Minerals Inc.

Enclosed are claim maintenance fees in the amount of \$775.00 [\$155.00 per Claim] for the Claims listed below:

<u>No.</u>	<u>IMC NUMBER</u>	<u>CLAIM NAME</u>
1.	427575	GB-1
2.	427576	GB-2
3.	427577	GB-3 Fraction
4.	428294	GB-4
5.	428295	GB-5

Located in T26N, R21W, Section 4 and T27N, R21W, Section 33, and recorded in the records of Mohave County, Arizona as Fee #2014012159, 2014012160, 2014012161 and as Fee #2014025479, 2014025480 for the benefit of Ivy Minerals Inc.

Submitted by:



Conway G. Ivy
Ivy Minerals Inc.
P.O. Box 2532
Boise, Idaho 83701
843-379-0316 [land] 440-796-7503 [cell]

RECEIVED
BUREAU OF LAND MANAGEMENT
PHOENIX, ARIZONA
2017 JUN 20 P 2:37



fedex.com 1800.GoFedEx 1800.463.3339

FedEx Express Package US Airbill

FedEx Tracking Number 8105 8824 2420

Form ID No. 0200
4 Express Package Servi

FedEx TRK# 8105 8824 2420

TUE - 20 JUN AA
STANDARD OVERNIGHT

85004
AZ-US
PHX

XH ZSYA



1 From
Date 6-19-2017
Sender's Name CONROY & Ivy
Company IIV PROPERTIES INC
Address 501 KING ST
City Phoenix State AZ ZIP 85002

2 Your Internal Billing Reference

3 To Recipient's Name
Company U.S. Department of Land Management
Address Suite 300
City Phoenix State AZ ZIP 85004-4121

Next Business Day

FedEx First Overnight
Earliest next business morning delivery to a location. Friday shipments will be delivered Monday unless Saturday delivery is selected.

FedEx Priority Overnight
Next business morning. Friday shipments will be delivered on Monday unless Saturday delivery is selected.

FedEx Standard Overnight
First business afternoon. Saturday delivery NOT available.

5 Packaging *Declared value limit \$500.

FedEx Envelope* FedEx Pak* FedEx box FedEx Tube Other

6 Special Handling and Delivery Options Fees may apply. See the FedEx Service Guide.

Saturday Delivery NOT available for FedEx Standard Overnight.

No Signature Require Package may be left without obtaining a signature for delivery.

Does this shipment contain dangerous goods? No Yes As per attached Shipper's Declaration. Yes Shipper's Declaration not required.

Restrictions apply for dangerous goods — see the current FedEx Service Guide.

Payment Bill to: Enter FedEx Acct. No. or Credit Card No. below.

Sender Acct. No. in Section 1 will be billed. Recipient Third Party

Credit Card Cash/Check

Total Packages Total Weight

Credit Card Auth. 644



8105 8824 2420

RTD 841597 19JUN17 SAVA 646C1/A602/PC8A

FedEx 2Day Second business afternoon. Thursday shipments will be delivered on Monday unless Saturday delivery is selected.

FedEx Express Saver Third business day. Saturday delivery NOT available.

RT 278
ST 1.2
15:00
06:20

Indirect Signature
No one is available at recipient's address, someone at a neighboring address may sign for delivery. For business only.

aircraft Only

fedex.com 1800.GoFedEx 1800.463.3339

Insert shipping document here.

Your liability is limited to US\$100 unless you declare a higher value. See the current FedEx Service Guide for details.
Rev. Date 3/15 • Part #167002 • ©2012-2015 FedEx • PRINTED IN U.S.A. RR0A 0630

FedEx
Express



earthsmart

FedEx carbon-neutral
envelope shipping

Align top of FedEx Express® shipping label here.

Envelope

RECEIVED
BLM AZ STATE OFFICE
2017 JUN 20 P 2:37
PHOENIX, ARIZONA

United States Department of the Interior
Bureau of Land Management
 DIV OF LANDS, MINRLS & ENERGY
 ONE N CENTRAL AVE
 PHOENIX, AZ 85004 -4427
 Phone: 602-417-9200

Receipt

No: 3867508

Transaction #: 3976467	
Date of Transaction: 06/21/2017	
CUSTOMER:	
IVY MINERALS INC PO BOX 2532 BOISE, ID 83701-2532 US	

LINE #	QTY	DESCRIPTION	REMARKS	UNIT PRICE	TOTAL
1	1.00	LOCATABLE MINERALS / MINING CLAIMS- NOT NEW-UNADJUD, ONE AUTH NO. ONLY / MINING CLAIM MONEY RECEIVED CASES: AMC427575/\$775.00	MAINT 2018/5	- n/a -	775.00
TOTAL:					\$775.00

PAYMENT INFORMATION					
1	AMOUNT:	775.00	POSTMARKED:	06/19/2017	
	TYPE:	CHECK	RECEIVED:	06/20/2017	
	CHECK NO:	3391			
	NAME:	IVY MINERALS INC PO BOX 2532 BOISE ID 83701-2532 US			

REMARKS

This receipt was generated by the automated BLM Collections and Billing System and is a paper representation of a portion of the official electronic record contained therein.

Ivy Minerals Inc.
P.O. Box 2532
Boise, Idaho 83701

July 16, 2016

427575
428294
RECEIVED
BLM AZ STATE OFFICE
2016 JUL 19 P 3:08
PHOENIX, ARIZONA

VIA FEDERAL EXPRESS

United States Bureau of Land management
Suite 800
One North Central Avenue
Phoenix, Arizona 85004-4427

Re: Maintenance Fee Payment for GB-1 through GB-5 Claims
Mohave County, Arizona

**BLM Serial #'s IMC # 427575 through #427577
and IMC# 428294 and #428295**

Greetings:

Enclosed is a check in the amount of \$775.00 in payment of the Maintenance Fees due on or before September 1, 2016 for the above referenced unpatented lode mining claims. I have enclosed a self-addressed stamped envelope for returning the receipt.

Thank you for your help in this matter.

Sincerely,

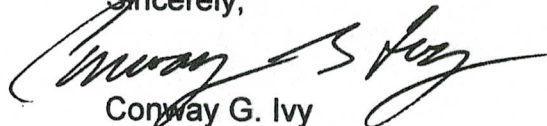

Conway G. Ivy
President

RECEIPT # 3610127

ENTERED
JUL 21 2016
BY: RAM

UNITED STATES BUREAU OF LAND MANAGEMENT
CLAIM MAINTENANCE FEES

July 16, 2016

For
Ivy Minerals Inc.

Enclosed are claim maintenance fees in the amount of \$775.00 [\$155.00 per Claim] for the Claims listed below:

<u>No.</u>	<u>IMC NUMBER</u>	<u>CLAIM NAME</u>
1.	427575	GB-1
2.	427576	GB-2
3.	427577	GB-3 Fraction
4.	428294	GB-4
5.	428295	GB-5

Located in T26N, R21W, Section 4 and T27N, R21W, Section 33, and recorded in the records of Mohave County, Arizona as Fee #2014012159, 2014012160, 2014012161 and as Fee #2014025479, 2014025480 for the benefit of Ivy Minerals Inc.

Submitted by:

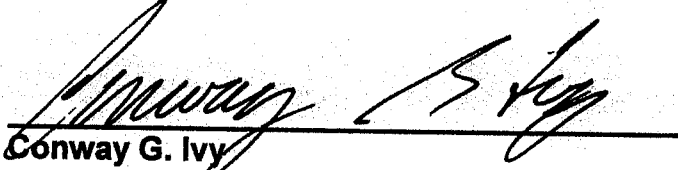
Conway G. Ivy
Ivy Minerals Inc.
P.O. Box 2532
Boise, Idaho 83701
843-379-0316 [land] 440-796-7503 [cell]

RECEIVED
BLM ARIZONA STATE OFFICE
2016 JUL 19 P 3:08
PHOENIX, ARIZONA



ST 1.2
RT 278
10:30
D
4512
8120

FedEx
TRK# 8055 8735 4512
0200

TUE - 19 JUL 10:30A
PRIORITY OVERNIGHT

85004
AZ-US
PHX

XH ZSYA

Extre



FID 941697 18JUL16 SAVA 639C1/5C6D/89D2

FedEx NEW Package
Express US Airbill

FedEx Tracking Number 8055 8735 4512

0200

1 From
Date 7/18/16
Sender's Name Comway & Ivy Phone 440 796-7503
Company IUV MINERALS INC
Address 501 King Street Dept./Floor/Suite/Room
City Beaufort State SC ZIP 29902

2 Your Internal Billing Reference

3 To
Recipient's Name
Company U.S. BUREAU OF LAND MANAGEMENT
Address SUITE 800
Address ONE NORTH CENTRAL AVENUE
City PHOENIX State AZ ZIP 85004-4420

4 Express Package Service * To most locations. Packages up to 150 lbs.
NOTE: Service order has changed. Please select carefully. For packages over 25 lbs., use the new FedEx Express Freight US Airmail.

Next Business Day	2 or 3 Business Days
<input type="checkbox"/> FedEx First Overnight Earliest next business morning delivery to select locations. Friday shipments will be delivered on Monday unless SATURDAY Delivery is selected.	<input type="checkbox"/> FedEx 2Day A.M. Second business morning. Saturday Delivery NOT available.
<input checked="" type="checkbox"/> FedEx Priority Overnight Next business morning. Friday shipments will be delivered on Monday unless SATURDAY Delivery is selected.	<input type="checkbox"/> FedEx 2Day Second business afternoon. Thursday shipments will be delivered on Monday unless SATURDAY Delivery is selected.
<input type="checkbox"/> FedEx Standard Overnight Next business afternoon. Saturday Delivery NOT available.	<input type="checkbox"/> FedEx Express Saver Third business day. Saturday Delivery NOT available.

5 Packaging * Declared value limit \$500.

FedEx Envelope* FedEx Pak* FedEx Box FedEx Tube Other

6 Special Handling and Delivery Signature Options

SATURDAY Delivery
NOT available for FedEx Standard Overnight, FedEx 2Day A.M., or FedEx Express Saver.

No Signature Required
Package may be left without obtaining a signature for delivery.

Direct Signature
Someone at recipient's address may sign for delivery. Fee applies.

Indirect Signature
If no one is available at recipient's address, someone at a neighboring address may sign for delivery for residential, delivery city. Fee applies.

Does this shipment contain dangerous goods?
One box must be checked.

No Yes
All per attached Shipper's Declaration.

Yes
Shipper's Declaration not required.

Dry Ice
Dry Ice, 9 UN 1845

Cargo Aircraft Only

Dangerous goods (including dry ice) cannot be shipped in FedEx packaging or placed in a FedEx Express Drop Box.

7 Payment Bill to:

Enter FedEx Acct. No. or Credit Card No. below. Obtain 1099-Acct. No.

Sender Acct. No. in Section 1 and 2 of Bill. Recipient Third Party Credit Card Cash/Check

Total Packages Total Weight Credit Card Auth.

*Our liability is limited to US\$100 unless you declare a higher value. See the current FedEx Service Guide for details.

644

Rev. Date U12 • Part 11E1002 • ©2012 FedEx • PRINTED IN U.S.A. SRP

fedex.com 1.800.GoFedEx 1.800.463.3339

fedex.com 1.800.GoFedEx 1.800.463.3339

Insert shipping document here.



8055 8735 4512

FedEx Express

earth smart
FedEx carbon-neutral
envelope shipping

Align top of FedEx Express® shipping label here.

Envelope

RECEIVED
BLM AZ STATE OFFICE
2016 JUL 19 P 2:36
PHOENIX, ARIZONA

United States Department of the Interior
Bureau of Land Management
 DIV OF LANDS, MINRLS & ENERGY
 ONE N CENTRAL AVE
 PHOENIX, AZ 85004 -4427
 Phone: 602-417-9200

Receipt

No: 3610127

Transaction #: 3713637	
Date of Transaction: 07/20/2016	
CUSTOMER:	
IVY MINERALS INC PO BOX 2532 BOISE, ID 83701-2532 US	

LINE #	QTY	DESCRIPTION	REMARKS	UNIT PRICE	TOTAL
1	1.00	LOCATABLE MINERALS / MINING CLAIMS- NOT NEW-UNADJUD, ONE AUTH NO. ONLY / MINING CLAIM MONEY RECEIVED CASES: AMC427575/\$775.00	MAINT FEE 2017 - 5	- n/a -	775.00
TOTAL:					\$775.00

PAYMENT INFORMATION					
1	AMOUNT:	775.00	POSTMARKED:	07/18/2016	
	TYPE:	CHECK	RECEIVED:	07/19/2016	
	CHECK NO:	3165			
	NAME:	IVY MINERALS INC PO BOX 2532 BOISE ID 83701-2532 US			

REMARKS

This receipt was generated by the automated BLM Collections and Billing System and is a paper representation of a portion of the official electronic record contained therein.

Ivy Minerals Inc.
P.O. Box 2532
Boise, Idaho 83701

June 17, 2015

427575
428294

VIA FEDERAL EXPRESS

United States Bureau of Land management
Suite 800
One North Central Avenue
Phoenix, Arizona 85004-4427

Re: Maintenance Fee Payment for GB-1 through GB-5 Claims
Mohave County, Arizona

Greetings:

Enclosed is a check in the amount of \$775.00 in payment of the Maintenance Fees due on or before September 1, 2015 for the above referenced unpatented lode mining claims. I have enclosed a self-addressed stamped envelope for returning the receipt.

Thank you for your help in this matter.

Sincerely,

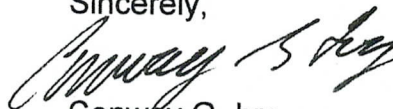

Conway G. Ivy
President

RECEIVED
BLM AZ STATE OFFICE
2015 JUN 19 A 9:43
PHOENIX, ARIZONA

ENTERED
JUN 24 2015
BY: R. Am

RECEIPT # 3326253

UNITED STATES BUREAU OF LAND MANAGEMENT
CLAIM MAINTENANCE FEES

June 17, 2015

MAINTENANCE FEE COST SUMMARY

For
Ivy Minerals Inc.

Enclosed are claim maintenance fees in the amount of \$775.00 [\$155.00 per Claim] for the Claims listed below:

<u>No.</u>	<u>IMC NUMBER</u>	<u>CLAIM NAME</u>
1.	427575	GB - 1
2.	427576	GB - 2
3.	427577	GB - 3 Fraction
4.	428294	GB - 4
5.	428295	GB - 5

Located in T26N, R21W, Section 4 and T27N, R21W, Section 33; and recorded in the records of Mohave County, Arizona as Fee # 2014012159, 2014012160, 2014012161 and as Fee # 2014025479, 2014025480;

For the benefit of Ivy Minerals Inc.

Submitted by:



Conway G. Ivy
Ivy Minerals Inc.
P.O. Box 2532
Boise, Idaho 83701
843-379-0316 [land] 440-796-7503 [cell]

RECEIVED
BLM AZ STATE OFFICE
2015 JUN 19 A 9:43
PHOENIX, ARIZONA

United States Department of the Interior
Bureau of Land Management
LANDS/RECREATION & PLANNING
ONE N CENTRAL AVE
PHOENIX, AZ 85004 -2203
Phone: 602-417-9200

Receipt

No: 3326253

Transaction #: 3423602	
Date of Transaction: 06/22/2015	
CUSTOMER:	
IVY MINERALS INC PO BOX 2532 BOISE, ID 83701-2532 US	

LINE #	QTY	DESCRIPTION	REMARKS	UNIT PRICE	TOTAL
1	1.00	LOCATABLE MINERALS / MINING CLAIMS- NOT NEW-UNADJUD, ONE AUTH NO. ONLY / MINING CLAIM MONEY RECEIVED CASES: AMC427575/\$775.00	MAINT FEE PYMNT (5) 2016	- n/a -	775.00
TOTAL:					\$775.00

PAYMENT INFORMATION			
1	AMOUNT:	775.00	POSTMARKED: N/A
	TYPE:	CHECK	RECEIVED: 06/19/2015
	CHECK NO:	2908	
	NAME:	IVY MINERALS INC PO BOX 2532 BOISE ID 83701-2532 US	

REMARKS

This receipt was generated by the automated BLM Collections and Billing System and is a paper representation of a portion of the official electronic record contained therein.

ENTERED
JUN 24 2015
BY: *RAM*

6/22/2015

FedEx NEW Package
Express US Airbill

Tracking Number **8061 6467 1003**

0200

1 From
Date **6/18/2015**

Sender's Name **Conway B Inv** Phone **440 796 7513**

Company **Inv Minerals Inc**

Address **P.O. Box 1408**

City **Beaufort** State **SC** ZIP **29901**

2 Your Internal Billing Reference

3 To
Recipient's Name _____ Phone _____

Company **UNITED STATES BUREAU OF LAND MANAGEMENT**

Address **SUITE 800**

Address **ONE NORTH CENTRAL AVENUE**

City **PHOENIX** State **AZ** ZIP **85004-4427**

4 Express Package Service
NOTE: Service order has changed. Please select carefully.

Next Business Day
 FedEx First Overnight
 FedEx Priority Overnight
 FedEx Standard Overnight

2 or 3 Business Days
 FedEx 2Day A.M.
 FedEx 2Day
 FedEx Express Saver

5 Packaging
 FedEx Envelope* FedEx Pak* FedEx Box

6 Special Handling and Delivery Signature Options

SATURDAY Delivery
 No Signature Required
 Direct Signature
 Indirect Signature

Does this shipment contain dangerous goods?
 No Yes Yes (Dry Ice)
 Dry Ice Cargo Aircraft Only

7 Payment: Bill Me

Sender from No. in Section 4
 Recipient Third Party Credit Card Cash/Check

Total Packages _____ Total Weight _____ Cash Card Amt. _____

fedex.com 1.800.GoFedEx 1.800.463.3339

fedex.com 1.800.GoFedEx 1.800.463.3339



8061 6467 1003

FedEx
TRK# **8061 6467 1003**

FRI - 19 JUN AA
STANDARD OVERNIGHT

XH ZSYA

85004
AZ-US
PHX



FD 158563 18JUN15 SAVA 522C1/BAHE/EE4B

RT 275
ST 6.2
16:00
D
1003
06.19

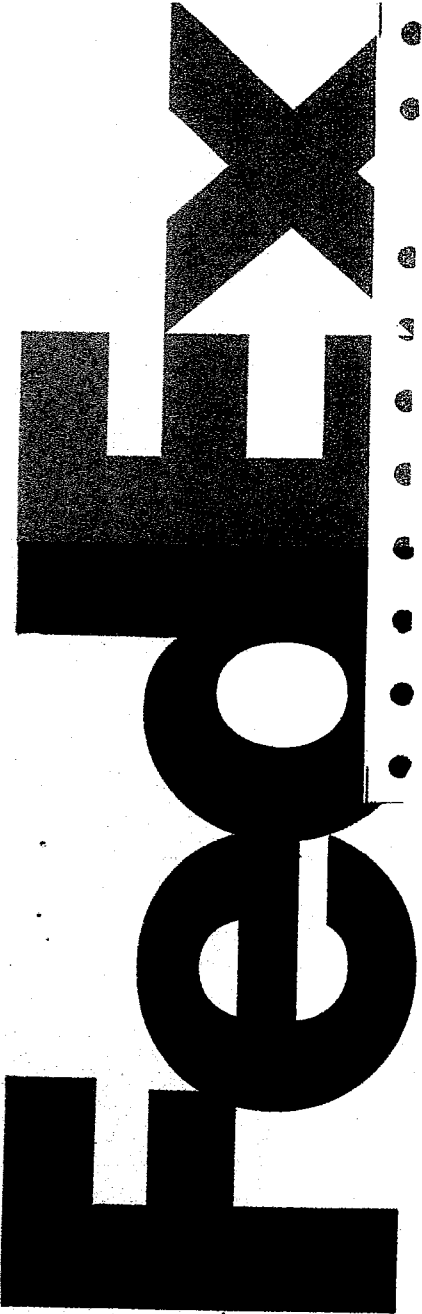

Amc 427575

428294

Ivy Minerals Inc.
P. O. Box 2532
Boise, Idaho 83701

July 21, 2014

VIA PRIORITY MAIL

United States Bureau of Land Management
Suite 800
One North Central Avenue
Phoenix, Arizona 85004-4427

Re: Maintenance Fee Payment for GB - 1 through GB - 5 Claims
Mohave County, Arizona

**BLM Serial #'s AMC # 427575 through AMC # 427577 and
AMC # 428294 and AMC # 428295**

Greetings:

Enclosed is a check in the amount of \$ 775.00 in payment of the 2015 maintenance fees for the above referenced unpatented lode mining claims. I have enclosed a self-addressed stamped envelope for returning the receipt. Thank you very much for your help in this matter.

Sincerely,

NO. OF CLAIMS 5
AMOUNT \$775.00
RECEIPT NO. 3084955
INIT. C.A.H.

** BLM-ASO**

ENTERED
JUL 28 2014
BY: RAM

PHOENIX, ARIZONA

2014 JUL 24 P 11:07

RECEIVED
BLM-ASO

**UNITED STATES BUREAU OF LAND MANAGEMENT
CLAIM MAINTENANCE FEES**

July 21, 2014

Enclosed are claim maintenance fees in the amount of \$ 775.00 [\$155.00 per claim] for the Claims listed below:

<u>No.</u>	<u>IMC NUMBER</u>	<u>CLAIM NAME</u>
✓ 1.	427575	GB - 1
✓ 2.	427576	GB - 2
3.	427577	GB - 3 Fraction
✓ 4.	428294	GB - 4
✓ 5.	428295	GB - 5

Located in T26N, R21W, Section 04 and T27N, R21W, Section 33; and recorded in the records of Yavapai County, Arizona as Fee # 2014012159, 2014012160, 2014012161 and as Fee # 2014025479, 2014025480 for the benefit of Ivy Minerals Inc.

Submitted by:

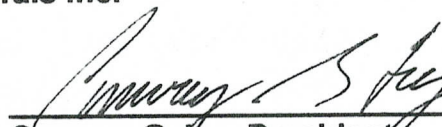

Conway G. Ivy, President
Ivy Minerals Inc.
P.O. Box 2532
Boise, Idaho 83701
440 - 796 - 7503 [telephone]

RECEIVED
BLM / SERVICE
2014 JUL 24 P 4: 01
PHOENIX, ARIZONA

United States Department of the Interior
Bureau of Land Management
 LANDS/RECREATION & PLANNING
 ONE N CENTRAL AVE
 PHOENIX, AZ 85004 -2203
 Phone: 602-417-9200

ENTERED
 JUL 28 2014
 BY: *ARKM*

Receipt

No: 3084955

Transaction #: 3176278	
Date of Transaction: 07/25/2014	
CUSTOMER:	
IVY MINERALS INC PO BOX 2532 BOISE, ID 83701-2532 US	

LINE #	QTY	DESCRIPTION	REMARKS	UNIT PRICE	TOTAL
1	1.00	LOCATABLE MINERALS / MINING CLAIMS- NOT NEW-UNADJUD, ONE AUTH NO. ONLY / MINING CLAIM MONEY RECEIVED CASES: AMC427575/\$775.00	MAINT FEE PYMNT (5) 2015	- n/a -	775.00
TOTAL:					\$775.00

PAYMENT INFORMATION					
1	AMOUNT:	775.00	POSTMARKED:	07/22/2014	
	TYPE:	CHECK	RECEIVED:	07/24/2014	
	CHECK NO:	2716			
	NAME:	IVY MINERALS INC PO BOX 2532 BOISE ID 83701-2532 US			

REMARKS

This receipt was generated by the automated BLM Collections and Billing System and is a paper representation of a portion of the official electronic record contained therein.

NOTICE!!

These documents have been scanned!

Do not place un-scanned documents beneath this notice!

Do not remove this notice from this file!

GPO Jacket No. 560-102
Print Order 61540
Rise Business Services, LLC
Job=AZ15 6/24/2019



Box Number= AZ15126



Claim Begin-End: AMC428294-AMC428295

5 Miscellaneous



AZ15126-3 AMC428281-AMC452898

**NO
DOCUMENTS
FOUND**

NO DOCUMENTS FOUND
NO DOCUMENTS FOUND

NOTICE!!

These documents have been scanned!

Do not place un-scanned documents beneath this notice!

Do not remove this notice from this file!

GPO Jacket No. 560-102
Print Order 61540
Rise Business Services, LLC
Job=AZ15 6/24/2019



Box Number= AZ15126



Claim Begin-End: AMC428294-AMC428295

6 Location Notices-Amendments and Supporting Documents



AZ15126-3 AMC428281-AMC452898

MINING CLAIM STATUS REPORT

Data Entered: 06/17/14 RAM

MTP Checked By: [Signature]

GEO Checked By: [Signature]

LEAD SERIAL NUMBER: AMC 428294 thru AMC 428295

NUMBER OF CLAIMS & TYPE:

CHARGES:

- 1 LODE
- 1 PLACER
- ASSOCIATION PLACER
- MILL SITE
- TUNNEL SITE

- Location Fee @ \$34 = \$ 68
- Processing Fee @ \$20 = \$ 40
- Maintenance Fee @ \$140 = \$ 280
- Add'l Maint Fee for Assoc Placer = \$ _____
- SUBTOTAL** \$ _____

TOTAL ACREAGE: 20 - per placer Per Claim
(Placer Only)

- Other Fees \$.13 - copy fee
- Other Fees \$ _____
- TOTAL** \$ 388.13

NUMBER OF LOCATORS: 1

DOCUMENTS RECEIVED VIA: Over-the-Counter [] Mail [] **TIMELY FILED:** Yes [] No []

LEGAL DESCRIPTION: T 26N R 21W SEC 4

T 27N R 21W SEC 33

T _____ R _____ SEC _____

T _____ R _____ SEC _____

T _____ R _____ SEC _____

BLM [] FOREST SERVICE [] SUBJ TO PL 359: Yes [] No []
WILDERNESS AREA [] _____

SPLIT ESTATE: N/A [] SX [] PX [] OTHER []
SRHA [] Was proper Notice filed if located on SHRA Land? Yes [] No []

RECONVEYED MINERALS ON BLM LAND REQUIRE OPENING ORDER FROM 1944 TO 1993:
Open to Entry On _____ N/A []

COMMENTS/STATUS: VOID [] PARTIALLY VOID [] PVT MINERALS [] WITHDRAWN LANDS []
OTHER [] _____

[] Claimant acknowledges that portions of the following claim(s) site(s) may be void or voidable.

Printed Name of Claimant _____ Signature of Claimant _____

*****FINAL ADJUDICATION*****

DATE 3-31-15 INITIALS RE

AMC 428294

When recorded
return to:

George Ryberg
534 Prescott Heights Dr.
Prescott, AZ 86301

^{Placer}
LOCATION NOTICE FOR ~~L~~ODI MINING CLAIM

NOTICE IS HEREBY GIVEN that the GB-4
lode mining claim has been located

by Ivy Minerals, Inc. whose current mailing
address is PO Box 2532
Boise, ID 83701

RECEIVED
BLM, AZ STATE OFFICE
2014 JUN -3 P 3:16
PHOENIX, AZ
BLM
Date
Stamp

The general course of this claim is North-South and it is situated in Mohave
County, Arizona. This claim is 1320 feet in length and 660 feet in width. This claim runs
from the location monument on which this location notice is posted approximately 50 feet in a
southerly direction to the south end line and 1270 feet in a northerly direction to the
North end line. This claim is marked by six monuments, one at each corner and one at the center of each
end line of the claim.

The location monument on which this notice is posted is situated within Section 33, Township 27
N, Range 21 W, Gila Salt River Base and Meridian, Arizona and this claim encompasses portions
of the following quarter section (s), section (s), Township (s) and Range (s) SE 1/4 Sec. 33,
T27 N R21 W.

Gila Salt River Base and Meridian, Arizona.

The locality of this claim with reference to some natural object or permanent monument and additional information
(if any) concerning its locality are as follows: The southeast corner of this claim
is located 430 feet north and 1320 feet west of
the southeast corner of Sec. 33, T27 N, R21 W.

DATED AND POSTED on the ground this 12th day of May, 2014.

LOCATOR (s) George E. Ryberg
Agent for Ivy Minerals, Inc.

Form MCF100
Revised July 2005

AMC428294

CLAIM MAP

Lode () Placer

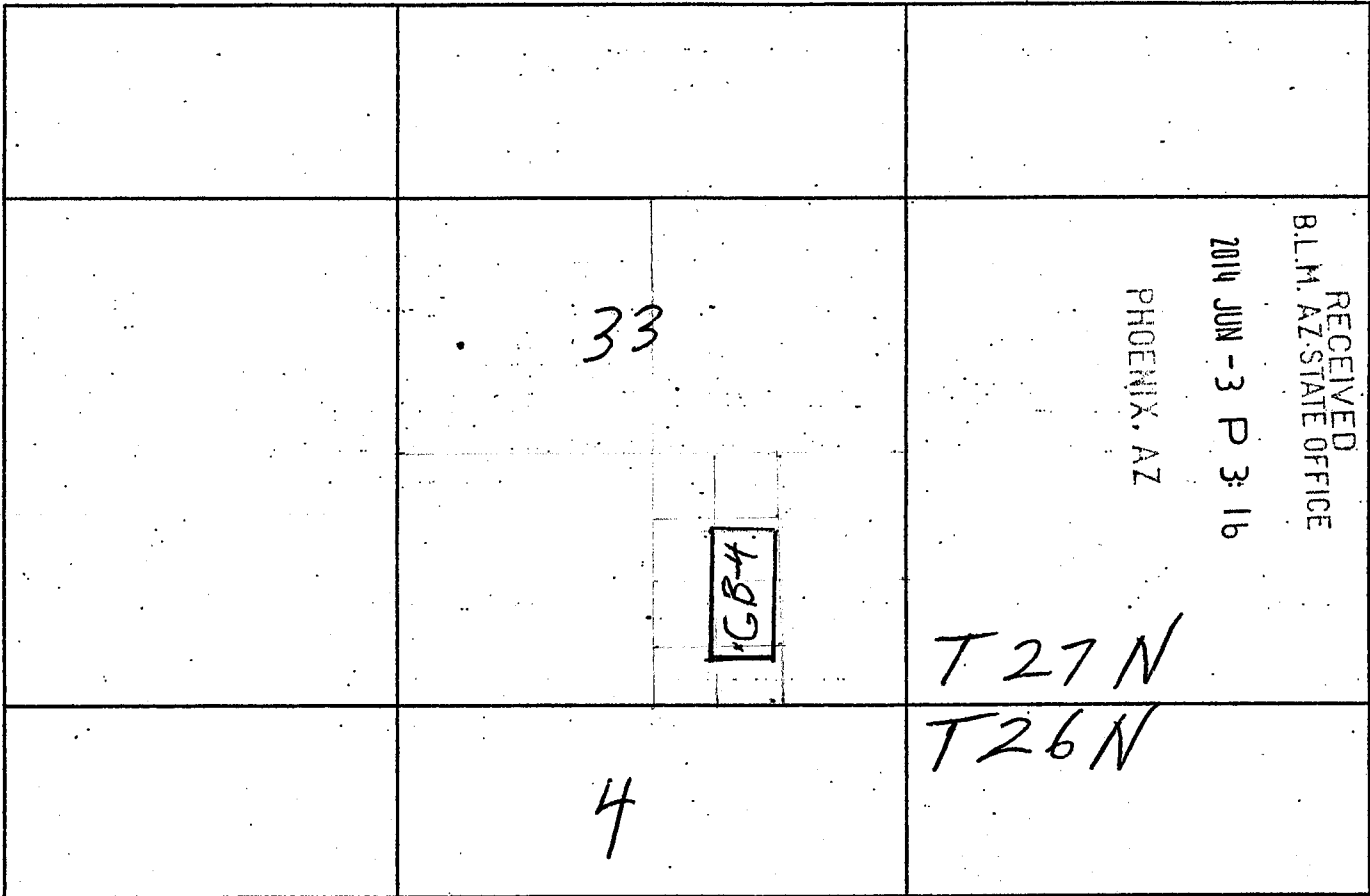

Scale: 1" = 2000'

1. The above map depicts the GB-4 mining claim, which is located in Section (s) 33, Township 27 N, Range 21 W, Gila and Salt River Base and Meridian, Mohave County, Arizona.

2. The type of corner and location monuments used are as follows: 2" x 2" posts 5 feet in length

3. The bearings and distances in degrees and feet between claim corners are as depicted on the map.

AMC 4 28294

When recorded
return to:

George Ryberg
534 Prescott Heights Dr.
Prescott, AZ 86301

LOCATION NOTICE FOR LODE MINING CLAIM

NOTICE IS HEREBY GIVEN that the GB-5

_____ lode mining claim has been located

by Ivy Minerals, Inc. whose current mailing

address is PO Box 2532

Boise, ID 83701

RECEIVED
D.L.M. AZ STATE OFFICE
2014 JUN -3 P 3:16
PHOENIX, AZ
BLM
Date
Stamp

The general course of this claim is East-West and it is situated in Mohave

County, Arizona. This claim is 1500 feet in length and 600 feet in width. This claim runs

from the location monument on which this location notice is posted approximately 20 feet in a

Easterly direction to the East end line and 1480 feet in a Westerly direction to the

West end line. This claim is marked by six monuments, one at each corner and one at the center of each end line of the claim.

The location monument on which this notice is posted is situated within Section 4, Township 26

N, Range 21 W, Gila Salt River Base and Meridian, Arizona and this claim encompasses portions

of the following quarter section (s), section (s), Township (s) and Range (s) NW 1/4, Sec. 4,

T 26 N, R 21 W.

Gila Salt River Base and Meridian, Arizona.

The locality of this claim with reference to some natural object or permanent monument and additional information

(if any) concerning its locality are as follows: The north west corner of this

claim is 1500 feet south and 400 feet east of the

northwest corner of Sec. 4, T 26 N, R 21 W

DATED AND POSTED on the ground this 12th day of May, 2014.

LOCATOR (s) George S. Ryberg
Agent for Ivy Minerals

Form MCF100
Revised July 2005

AMC428295

CLAIM MAP

Lode (X) Placer ()

	33	
	<div style="border: 1px solid black; display: inline-block; padding: 2px;">GB-5</div> 4	RECEIVED B.L.M. AZ STATE OFFICE 2014 JUN -3 P 3:16 PHOENIX, AZ
		T 27 N T 26 N

Scale: 1" = 2000'

1. The above map depicts the GB-5 mining claim, which is located in Section (s) 4, Township 26 N, Range 21 W, Gila and Salt River Base and Meridian, Mohave County, Arizona.

2. The type of corner and location monuments used are as follows: 5' 2" x 2"
Claim Posts

3. The bearings and distances in degrees and feet between claim corners are as depicted on the map.

AMC 428295

DEPARTMENT OF INTERIOR
BUREAU OF LAND MANAGEMENT

Input Parameters for Geographic Report with Land

System Id = CR

Admin State = AZ

Geo State =

Casetype Begins With

Case Disp Txt = AUTHORIZED, CANCELLED, EXPIRED, PENDING, REJECTED, RELINQUISHED, VOID, WITHDRAWN

Mer Twp Rng =

Section =

Mtrs = 14 0260N 0210W 004, 14 0260N 0210W 999, 14 0270N 0210W 033, 14 0270N 0210W 999

Commodity =

Commodity Txt =

Pending Org =

Pend Org Decode =

Total Rows Returned: 5

RUN TIME: 03:11 PM

UNITED STATES DEPARTMENT OF INTERIOR
BUREAU OF LAND MANAGEMENT
GEOGRAPHIC REPORT WITH LAND
Sorted by Serial Number

RUN DATE: 06/03/2014

Page 1 of 1

Adm State: AZ

Serial Number: AZA 029738
Total Case Acres: 6.970

<u>Casetype</u>	<u>Case Disp</u>				<u>Sect</u>	<u>Sur Typ</u>	<u>Sur Num</u>	<u>Suff</u>	<u>Subdivision</u>	<u>Act Pend</u>
286007	AUTHORIZED	14	0260N	0210W	004	ALIQ LOTS MNR		1	SWNW; 4; N2N2SW;	

Serial Number: AZA 029738
Total Case Acres: 6.970

<u>Casetype</u>	<u>Case Disp</u>				<u>Sect</u>	<u>Sur Typ</u>	<u>Sur Num</u>	<u>Suff</u>	<u>Subdivision</u>	<u>Act Pend</u>
286007	AUTHORIZED	14	0270N	0210W	033	ALIQ LOTS			E2SE; 1,2,3;	

Serial Number: AZA 030892
Total Case Acres: 1.000

<u>Casetype</u>	<u>Case Disp</u>				<u>Sect</u>	<u>Sur Typ</u>	<u>Sur Num</u>	<u>Suff</u>	<u>Subdivision</u>	<u>Act Pend</u>
285003	PENDING	14	0260N	0210W	004	MNR			SWSWSW;	Y

Serial Number: AZA 030892A
Total Case Acres: 1.000

<u>Casetype</u>	<u>Case Disp</u>				<u>Sect</u>	<u>Sur Typ</u>	<u>Sur Num</u>	<u>Suff</u>	<u>Subdivision</u>	<u>Act Pend</u>
286203	PENDING	14	0260N	0210W	004	MNR			SWSWSW;	Y

PARTIALLY SURVEYED TOWNSHIP 26 NORTH RANGE 21 WEST OF THE GILA AND SALT RIVER MERIDIAN, ARIZONA

STATUS OF PUBLIC DOMAIN
LAND AND MINERAL TITLES

MOHAVE COUNTY



INDEX TO SEGREGATED TRACTS			
RESURVEY	ORIGINAL SURVEY		
TRACT NO	T	R	SUBDIVISION

FOR ORDERS EFFECTING DISPOSAL OR USE OF UNIDENTIFIED LANDS WITHDRAWN FOR CLASSIFICATION, MINERALS, WATER AND/OR OTHER PUBLIC PURPOSES, REFER TO INDEX OF MISCELLANEOUS DOCUMENTS.

DIST. NO. 2
GRAZING DIST. NO. 2
MCS 501 RW
PROTRACTION DIAGRAM NO. 10

Empty lines for notes or additional information.

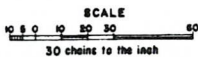

Lat. 35° 35' 18" N
Long. 114° 28' 52" W

CURRENT TO	BY
11/18/1998	JB
3/27/2000	JB
9/14/2000	JB

T. 26 N
R. 21 W

TOWNSHIP 27 NORTH RANGE 21 WEST OF THE GILA AND SALT RIVER MERIDIAN, ARIZONA

MOHAVE COUNTY

STATUS OF PUBLIC DOMAIN
LAND AND MINERAL TITLES

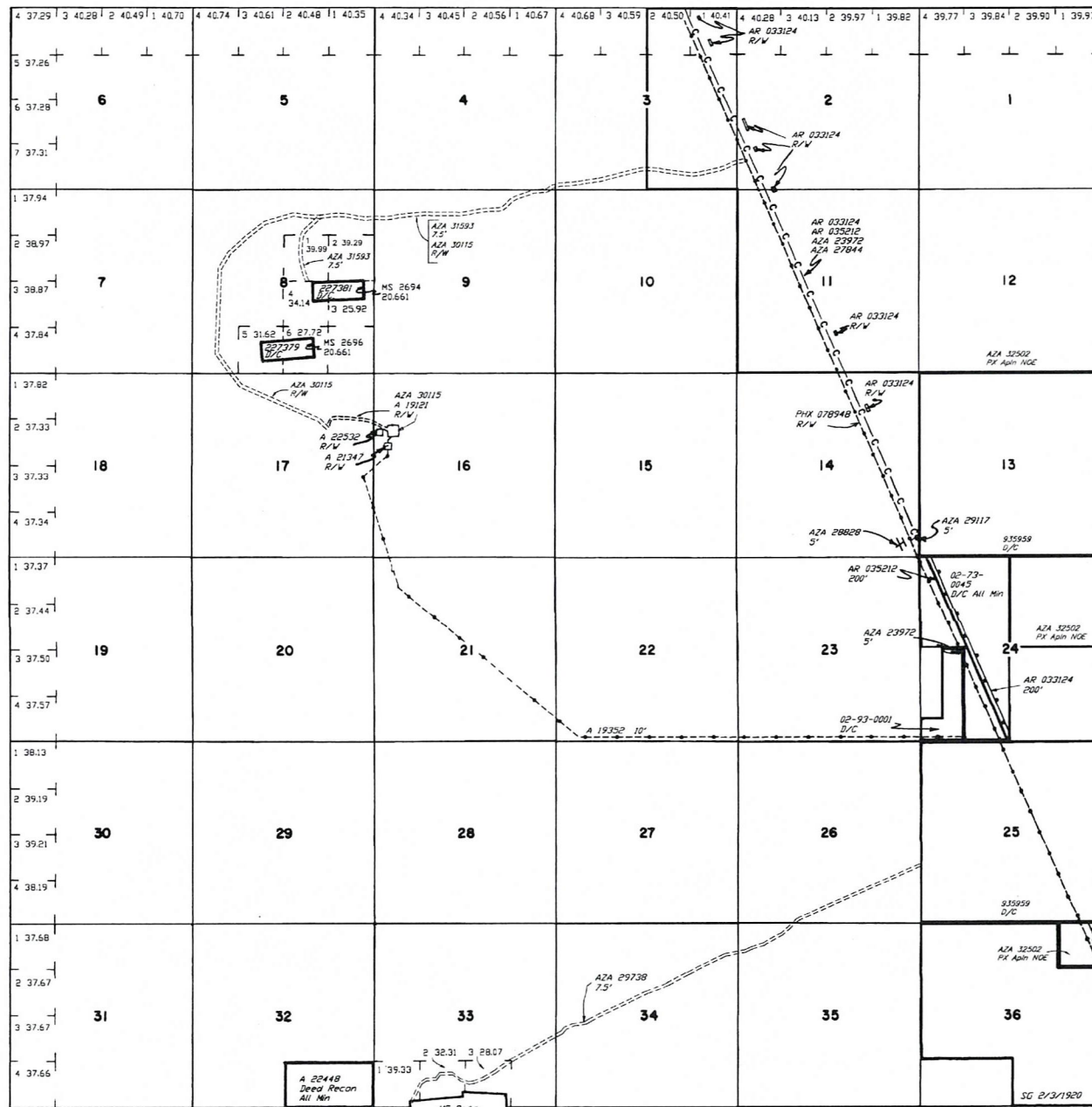

INDEX TO SEGREGATED TRACTS				
TRACT NO	RESURVEY		ORIGINAL SURVEY	
	T	R	SEC	SUBDIVISION

FOR ORDERS AFFECTING DISPOSAL OR USE OF UNIDENTIFIED LANDS WITHDRAWN FOR CLASSIFICATION, MINERALS, WATER AND/OR OTHER PUBLIC PURPOSES, REFER TO INDEX OF MISCELLANEOUS DOCUMENTS.

DIST NO 2

GRAZING DIST NO 2

MDS 504 NW

Lot 35°40'31"N
Long 114°28'52"W

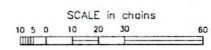

WARNING STATEMENT
This plot is the Bureau's Record of Title, and should be used only as a graphic display of the township survey data. Records hereon do not reflect title changes which may have been effected by lateral movements of rivers or other bodies of water. Refer to the cadastral surveys for official survey information.

CURRENT TO	GS	GSR Mer
3-31-2004	PV	T 27 N R 21 W